

Casper Hoher
now
Samuel Sherrick

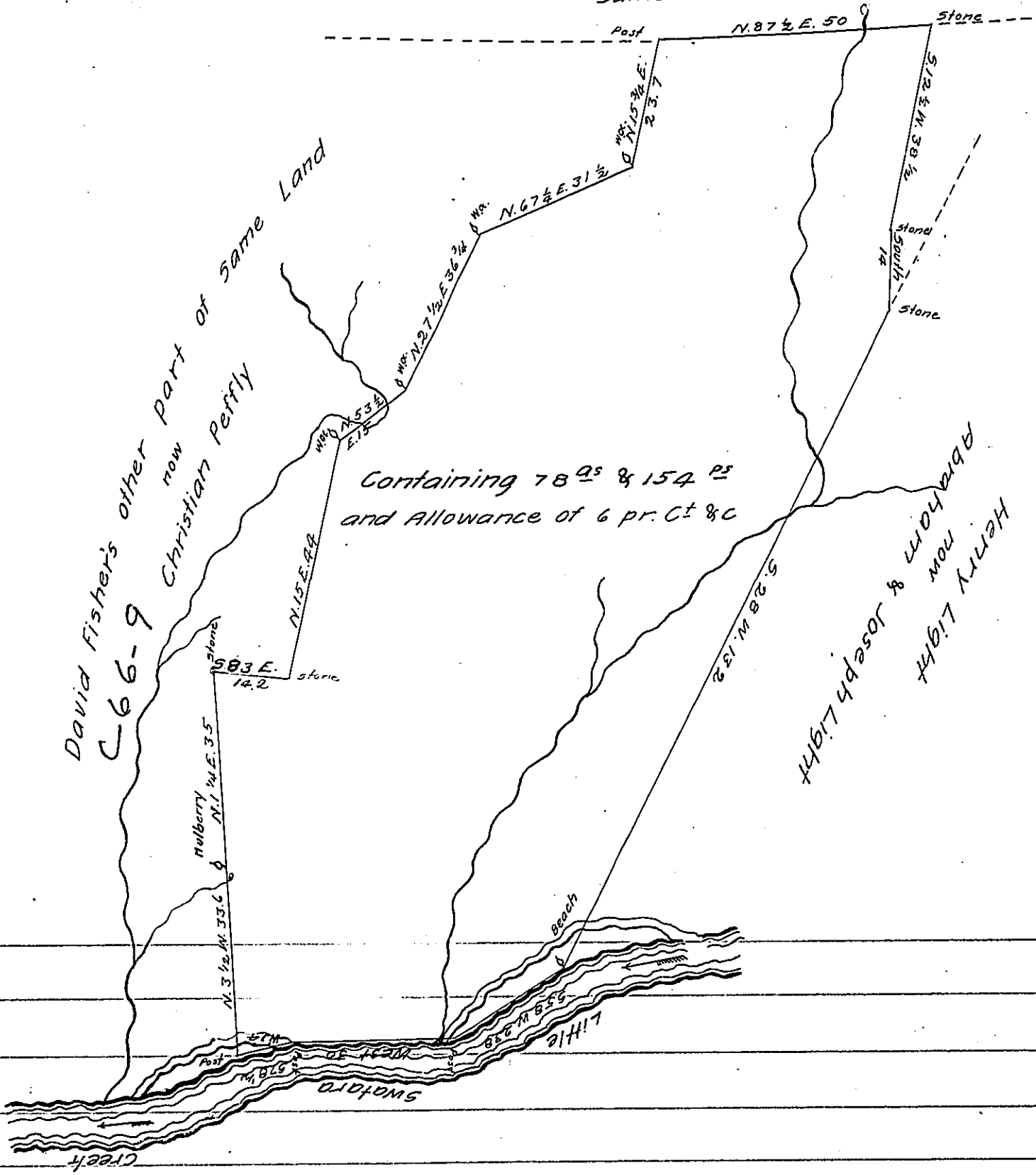

Draft of a tract of Land Situate in Bethel Township Lebanon County Containing Seventy Eight Acres and one hundred and fifty four perches and Allowance of 6 pr. Ct. It being part of a larger Tract of One Hundred and Eighty ^{six} Acres of Land, Granted by Warrant dated the 25th day of May A. D. 1749 unto David Fisher, surveyed the 30th day of September A. D. 1841 for Philip Hollenbach
 To Jacob Gallada
 Surveyor General of Pennsylvania

pr. Wm Rank D. S.

IN TESTIMONY that the above is a copy of the original remaining on file in the Department of Internal Affairs of Pennsylvania, made conformably to an Act of Assembly approved the 16th day of February, 1833, I have hereunto set my Hand and caused the Seal of said Department to be affixed at Harrisburg, this twenty fourth day of January 1905

Grace B. Perry
 Secretary of Internal Affairs.